

**RPX
SERIES**

RPX.V23.1



TRIMECCANICA

PROGETTAZIONE - COSTRUZIONE - ASSISTENZA

RPX

RIPPER TOOTH

Made in Italy

FOR MINI, MIDI, BACKHOE AND EXCAVATORS

Tooth ripper "RPX". The ideal choice for ripping hard ground, rocks, shale, hard clay and permafrost and any ground condition where normal bucket penetration is difficult, also used in construction along with other digging machines to prepare wells, canals and foundation trenches. Made of heavy-duty abrasion resistant steel 400HB, 450 HB and 400 HB. The wide range of models allows the perfect match for every excavator from 1,2 to 38 ton, providing the best performance for each specific class and application.



Reinforced
chassis



Shape
optimized
for
excavators



Interchangeable
penetration
tooth

RPX SERIES

RPX.V23.1

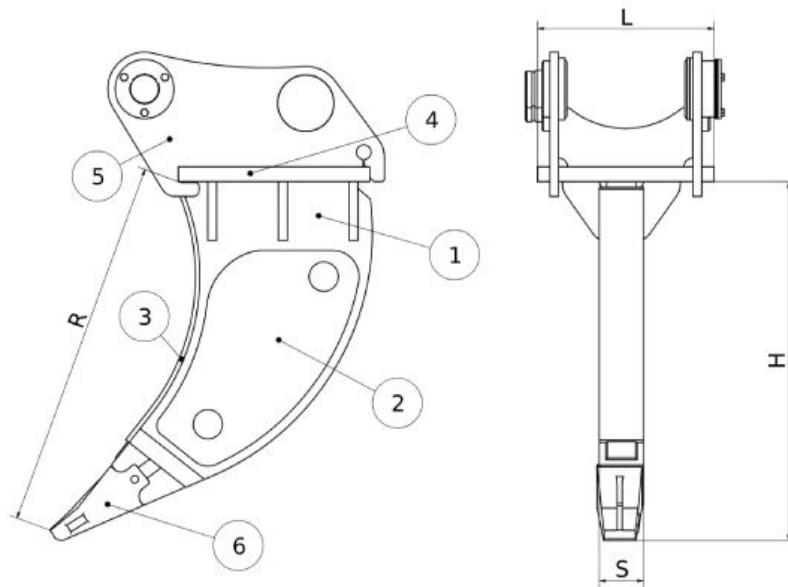
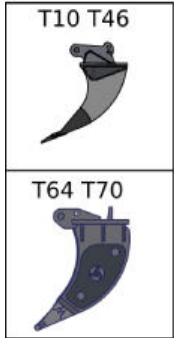

Technical features

Class	Operating weight (Q)	Thickness (mm)					
		1 S355	2 HB450	3 HB450	4 S355	5 S355	6 Dente
T20	9-28	15	15	-	15	10/12	E17
T30	28-60	20	20	-	20	12/15	E17
T46	70-120	30	20	-	25	15/20	E19
T58	120-190	50	15	15	30	25	25R12
T64	190-250	80	15	15	40	30	35R14A
T70	250-380	100	15	15	50	35/40	39R16A

Dimensions (mm)

Class	Kg	R	H	L	S
T20	36	550	500	250	45
T30	52	700	600	300	60
T46	155	800	700	350	70
T58	400	1000	1000	500	100
T64	600	1135	1200	500	120
T70	900	1260	1400	600	150

Optional:
• Quick coupler

• Different sizes available on request. Trimeccanica company reserves the right to change, modify or improve the characteristics above at any time and without any prior notice.